

Geared Motors Planetary Gearboxes

Key Data: Dynatork 3 Acetal

Motor Ref:
(Non-Lube) 911.35

for use with a dry, clean,
non-lubricated air supply

Maximum diameter (mm)	212
Output shaft dia.(mm)	19
Output shaft effective length (mm)	40
Maximum radial shaft load (N)	600
at (L) distance from face (mm)	20
Max. continuous output torque (Nm)	80
Weight 1 stage (kg)	5.5
Weight 2 stage (kg)	6.5
Weight 3 stage (kg)	8.5

- Robust, Compact and efficient planetary gear units
- Ratios from 3.7:1 to 308:1
- Output speeds from 0.6 to 162.2 rev/min
- Maximum continuous output torque for single stage gearboxes is 20Nm, two stage 60Nm and three stage 80Nm.

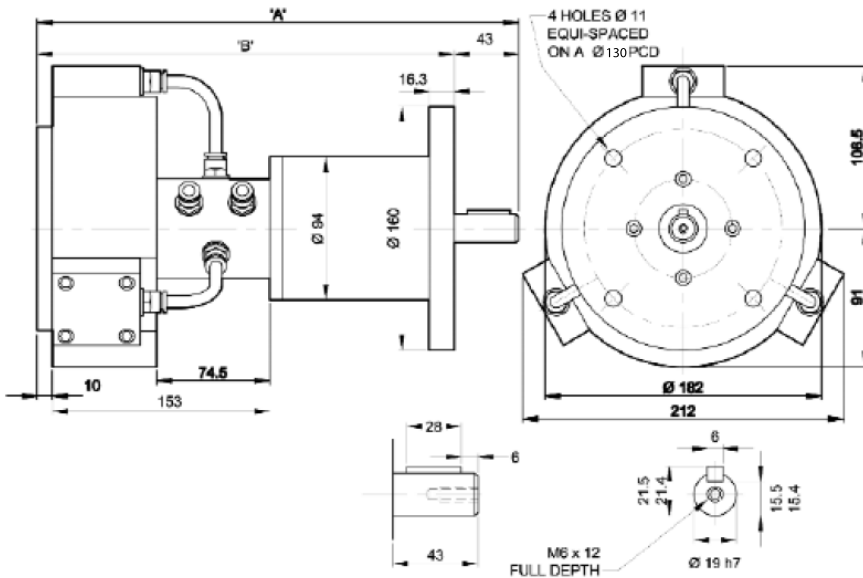
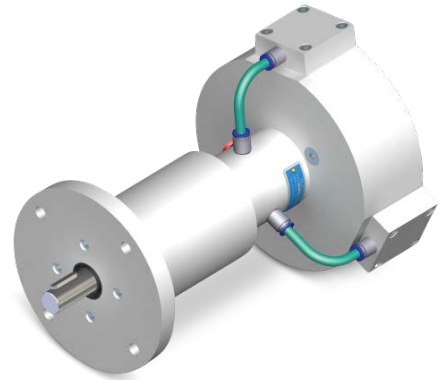

911.35	Dim A	Dim B
1-Stage	320mm	277mm
2-Stage	342mm	299mm
3-Stage	363mm	321mm

Speed/Ratio Selection		Ratio Order Ref										
Motor ref:	911.35	01	02	03	04	05	06	07	08	09	10	11
Ratio:1 rev/min		3.7	6.75	13.73	19.2	25	29	46	51	93	169	308
600	•	162.2	88.9	43.7	31.3	24	20.7	13.0	11.8	6.5	3.6	1.9
500	•	135.1	74.1	36.4	26.0	20	17.2	10.9	9.8	5.4	3.0	1.6
400	•	108.1	59.3	29.1	20.8	16	13.8	8.7	7.8	4.3	2.4	1.3
300	•	81.1	44.4	21.8	15.6	12	10.3	6.5	5.9	3.2	1.8	1.0
200	•	54.1	29.6	14.6	10.4	8	6.9	4.3	3.9	2.2	1.2	0.6
		Single Stage			Two Stage				Three Stage			

For Output Torque

- 1 Locate the motor speed on the torque/speed graph on page 6 (size 1) or page 8 (size 3)
- 2 Select the appropriate input air pressure curve and, for the chosen speed, read off the torque on the vertical axis
- 3 Multiply this value by the chosen ratio to give the output torque